

TOP FIXTURE DETAIL
FOR DOORS LESS THAN 500 LBS OR
LESS THAN 5 SECTIONS TALL

TOP FIXTURE DETAIL
FOR DOORS ON LOW
HEADROOM TRACK

TOP FIXTURE DETAIL
FOR DOORS OVER 500 LBS OR
OVER 5 SECTIONS HIGH

RAIL DETAIL
.075 THICK ALUMINUM WALL
EXTRUSIONS

SECTION AND UBAR
DETAIL

END STILE DETAIL
.075 THICK ALUMINUM WALL
EXTRUSIONS

CENTER STILE DETAIL
.075 THICK ALUMINUM WALL
EXTRUSIONS

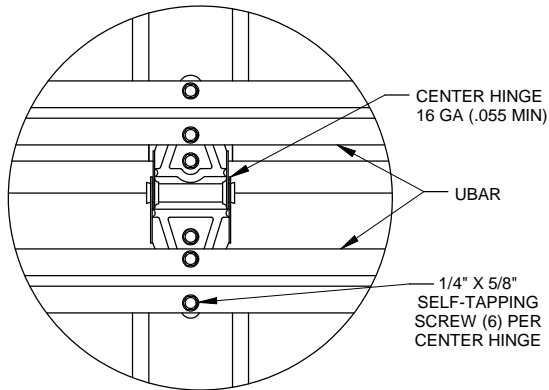

CENTER HINGE DETAIL

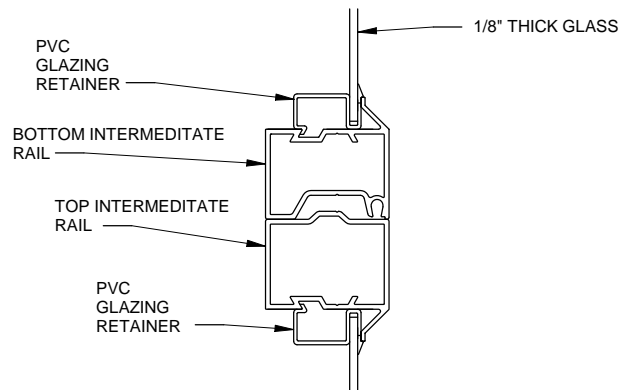

SECTION B-B
UBAR OMITTED FOR CLARITY

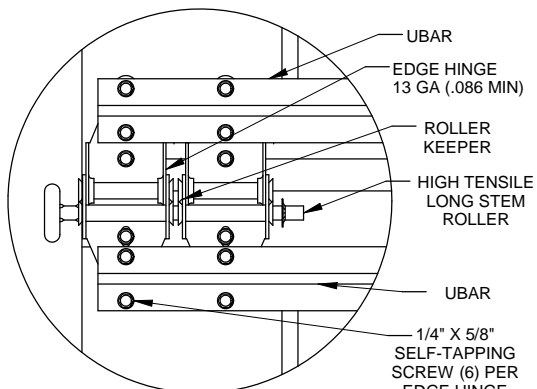

EDGE HINGE DETAIL
SINGLE END STILE

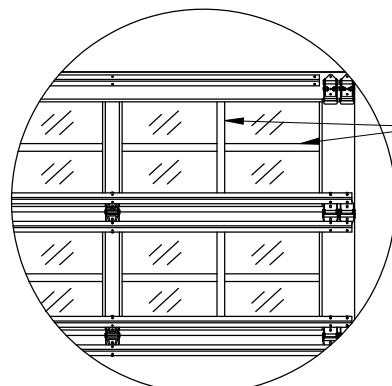

OPTIONAL WINDOW DIVIDERS

MAX. DOOR HEIGHT
ALUMAVIEW OPTIMA = 20' - 0"
STYLEVIEW WIDE PROFILE = 10' - 0"
STYLEVIEW CUSTOM PROFILE = 10' - 0"

MAXIMUM PANEL
OR GLASS SIZE =
37 1/4" X 19-3/4"

LOCKS REQUIRED
ON DOORS NOT
ELECTRICALLY
OPERATED

MAX. SECTION
HEIGHT = 26-1/2"

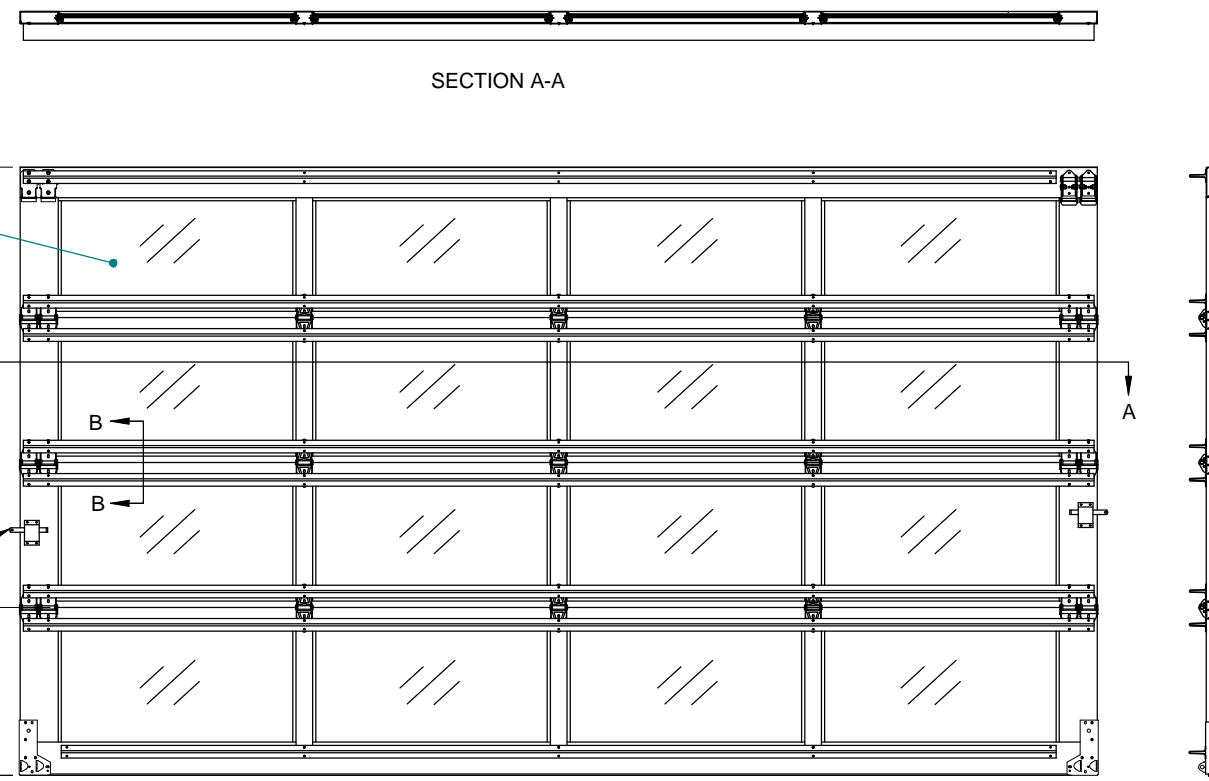

MAXIMUM DOOR WIDTH - 14'- 2"

INTERIOR ELEVATION

TRACK AND COUNTER BALANCE ASSEMBLIES
WERE OMITTED FROM ALL DETAILS ON THIS PAGE FOR CLARITY.
SEE SHEET 3 FOR TRACK AND COUNTER BALANCE DETAILS

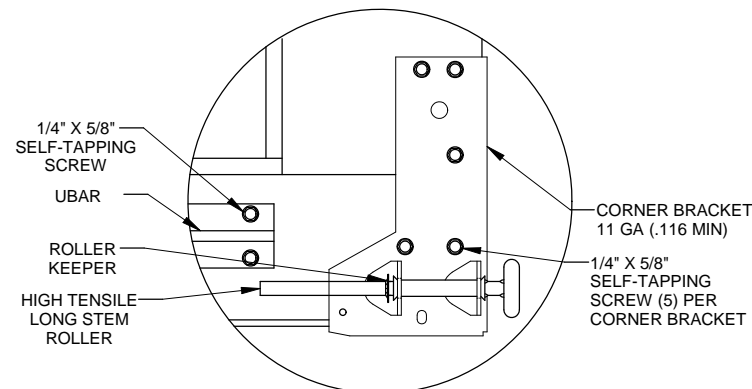

CORNER BRACKET DETAIL

DOORS TESTED PER
ANSI/DASMA 108
FOR STATIC AIR PRESSURE

MAXIMUM DOOR WIDTH	DESIGN LOAD	
14' - 2"	+ 43.0	- 48.0

Scott A. Brown P.E.
F.P.E #65940
698 Timber Creek Road
Dixon Illinois 61021

SCALE: NONE		DRAWN BY: G.WEDEKIND		TITLE: SPEC, WIND LOAD ALUMAVIEW AND STYLEVIEW	
B	WAS RICHARD A BAUMANN, P.E., 2) UPDATED JAMB ATTACHMENTS	7804.01	10/02/17	CHECKED BY: GW	RAYNOR GARAGE DOORS BOX 448 EAST RIVER ROAD DIXON, ILL. 61021
A	RELEASED FOR PRODUCTION	6338.01	06/14/12	DATE: 06/14/12	
REV.	DESCRIPTION	ECN. NO.	DATE	ECN. NO.: 6338.01	NO. P-2409
					SHEET 1 OF 4
					REV B

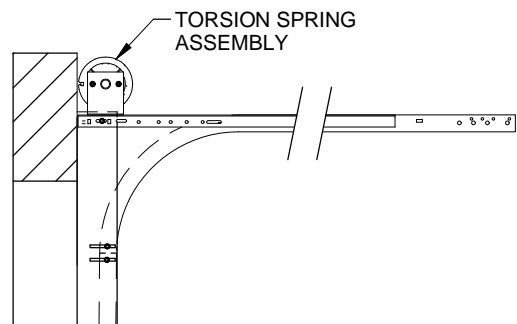

NORMAL HEADROOM TRACK
2" TRACK ANGLE MOUNT SHOWN
2" TRACK BRACKET MOUNT AVAILABLE
3" TRACK ANGLE MOUNT AVAILABLE

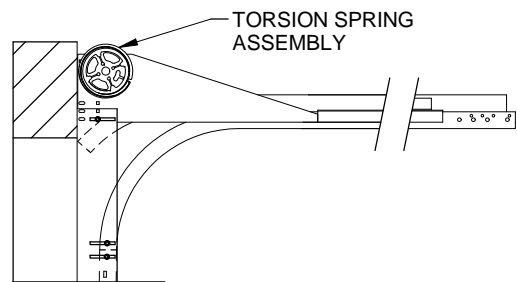

FRONT MOUNT LOW HEADROOM TRACK
2" TRACK ANGLE MOUNT SHOWN
2" TRACK BRACKET MOUNT AVAILABLE
3" TRACK ANGLE MOUNT AVAILABLE

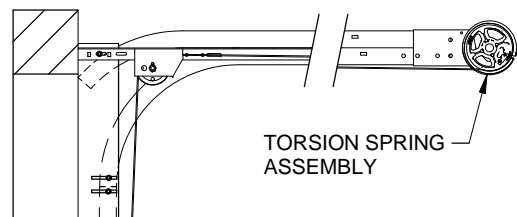

REAR MOUNT LOW HEADROOM TRACK
2" TRACK ANGLE MOUNT SHOWN
2" TRACK BRACKET MOUNT AVAILABLE
3" TRACK ANGLE MOUNT AVAILABLE

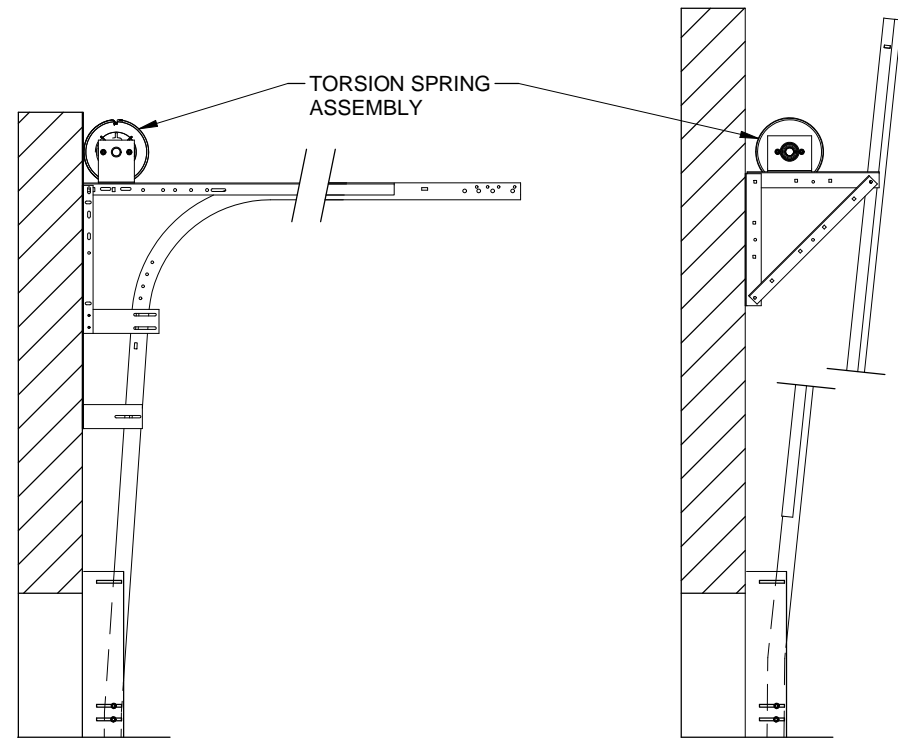

LIFT CLEARANCE TRACK
2" TRACK ANGLE MOUNT SHOWN
2" TRACK BRACKET MOUNT AVAILABLE
3" TRACK ANGLE MOUNT AVAILABLE

VERTICAL LIFT TRACK
2" TRACK ANGLE MOUNT SHOWN
2" TRACK BRACKET MOUNT AVAILABLE
3" TRACK ANGLE MOUNT AVAILABLE

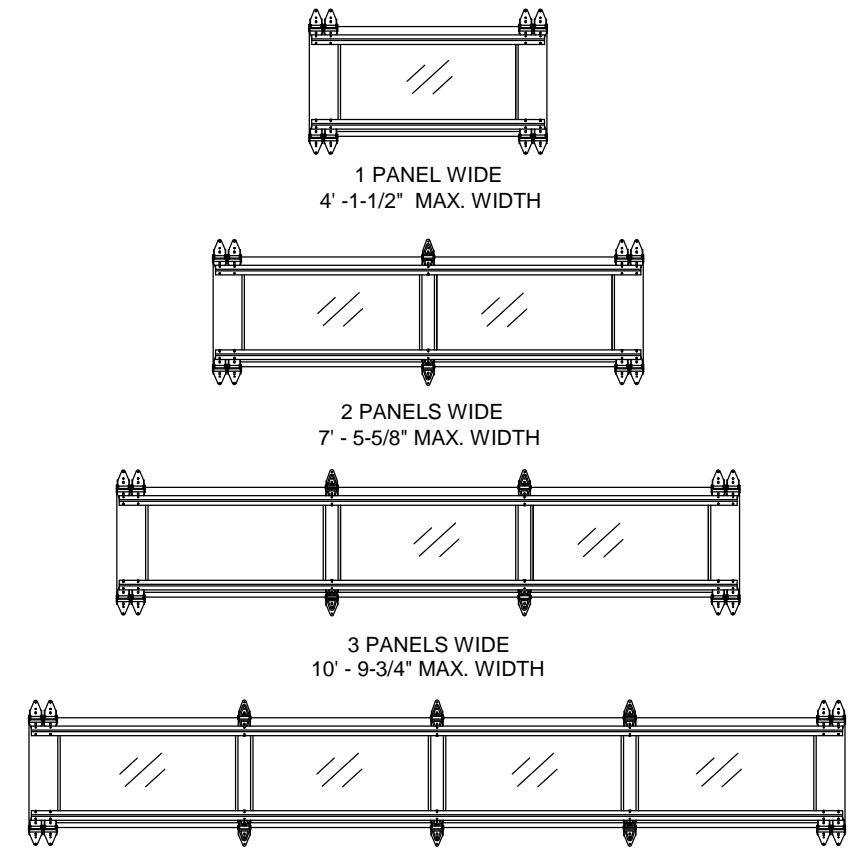

1 PANEL WIDE
4' - 1-1/2" MAX. WIDTH

2 PANELS WIDE
7' - 5-5/8" MAX. WIDTH

3 PANELS WIDE
10' - 9-3/4" MAX. WIDTH

4 PANELS WIDE
14' - 2" MAX. WIDTH

CENTER STILE AND PANEL LAYOUT
INTERIOR VIEW
INTERMEDIATE SECTION SHOWN

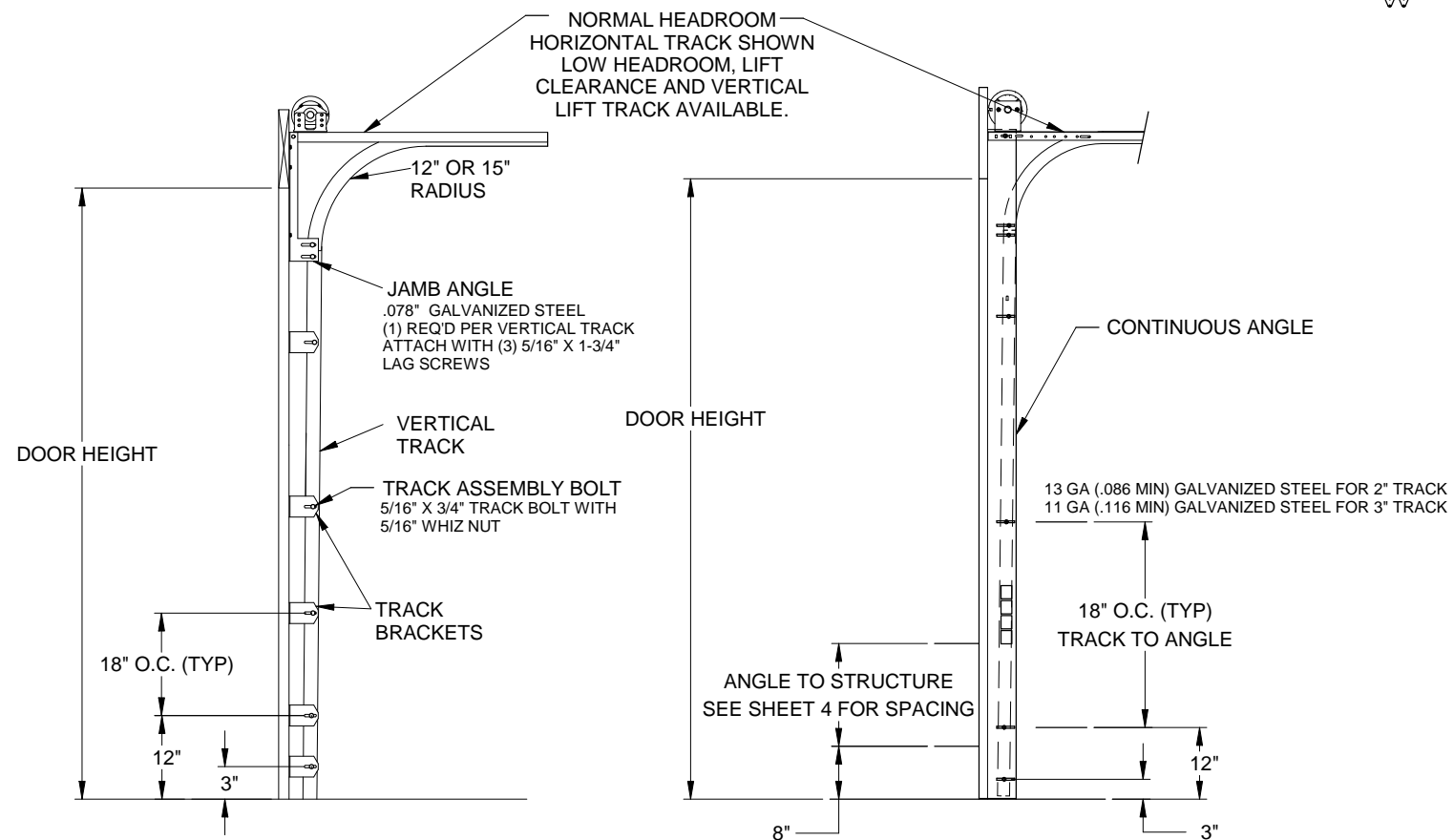

TYPICAL TRACK INSTALLATION
BRACKET MOUNT
WOOD JAMBS

TYPICAL TRACK INSTALLATION
ANGLE MOUNT
WOOD, STEEL OR MASONRY
JAMBS

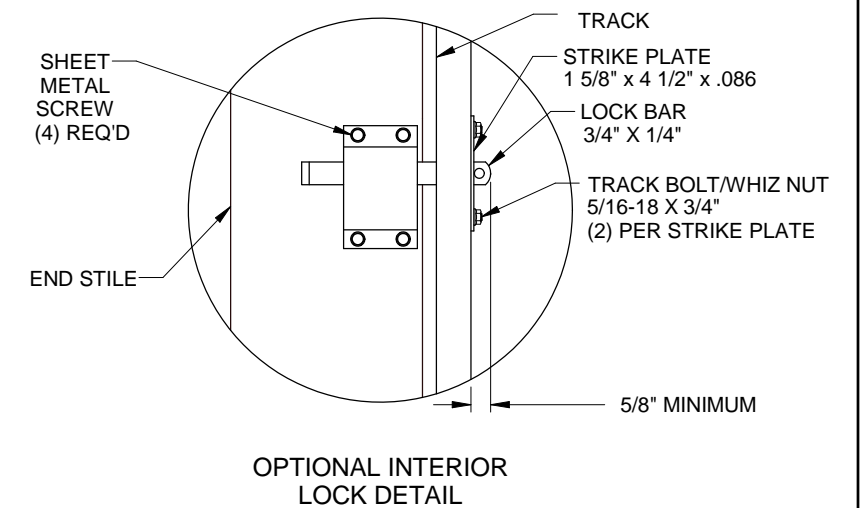

OPTIONAL INTERIOR
LOCK DETAIL

Scott A. Brown P.E.
F.P.E. #65940
698 Timber Creek Road
Dixon Illinois 61021

SCALE: NONE		TITLE: SPEC, WIND LOAD ALUMAVIEW AND STYLEVIEW
DRAWN BY: G.WEDEKIND		NO. P-2409
CHECKED BY: GW		
DATE: 06/14/12		REV B
ECN NO. 6338.01		

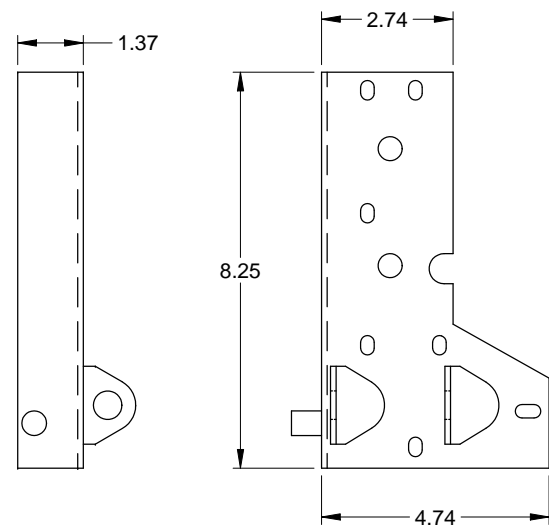

SCALE 1:2
CORNER BRACKET
(FOR DOORS OVER 600 LBS)
.116 GALV. STEEL

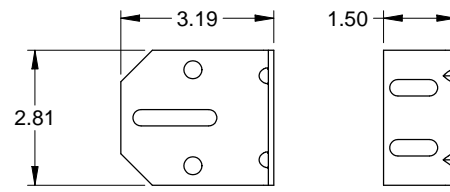

SCALE 1:2
3" TRACK BRACKET
.116 GALV. STEEL

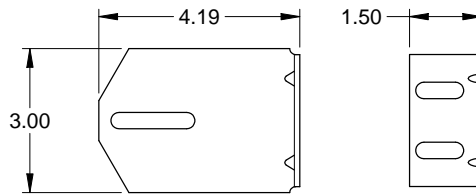

SCALE 1:2
4" TRACK BRACKET
.116 GALV. STEEL

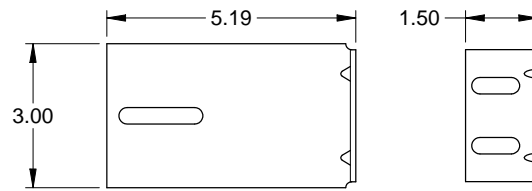

SCALE 1:2
5" TRACK BRACKET
.116 GALV. STEEL

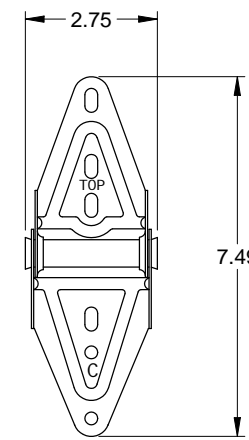

SCALE 1:2
CENTER HINGE
.045 GALV. STEEL

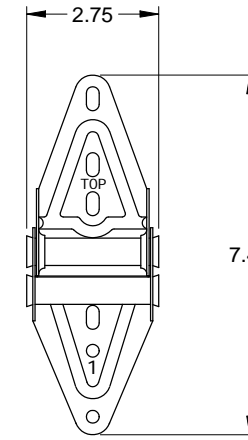

SCALE 1:2
EDGE HINGE
.086 GALV. STEEL

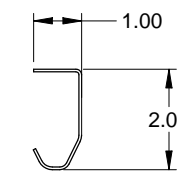

SCALE 1:2
2" TRACK
.086 MIN. GALV. STEEL

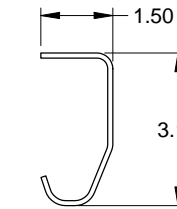

SCALE 1:2
3" TRACK (OPTIONAL)
.105 GALV. STEEL

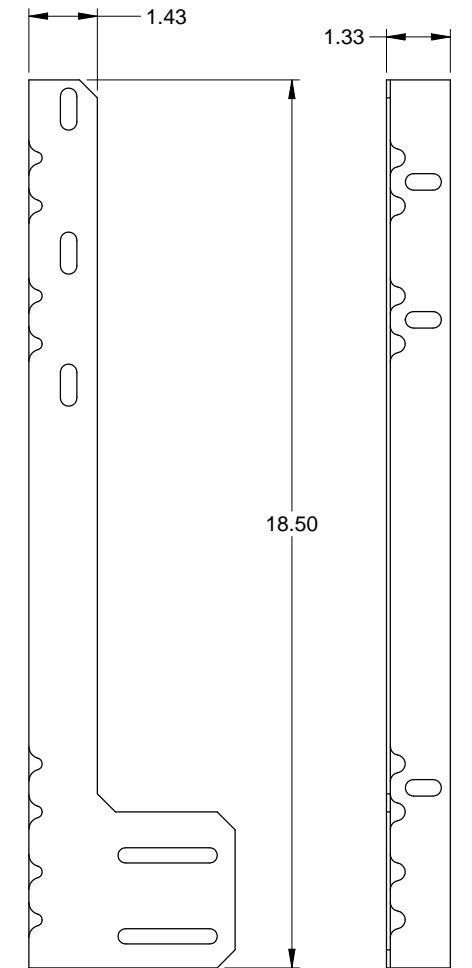

SCALE 1:2
JAMB ANGLE
.078 GALV. STEEL

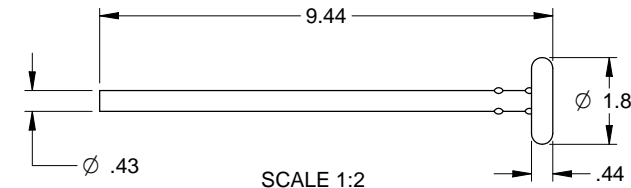

SCALE 1:2
LONG STEM HURRICANE
TRACK ROLLER

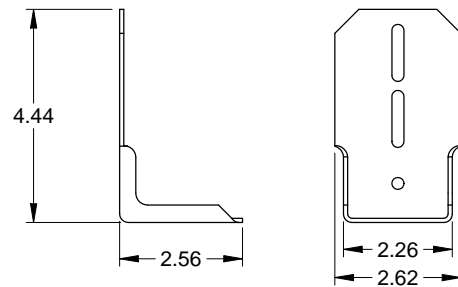

SCALE 1:2
LIGHT COMMERCIAL TOP FIXTURE
(FOR DOORS 5 SECTIONS HIGH OR LESS)
.086 GALV. STEEL

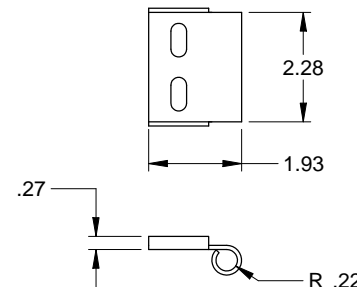

SCALE 1:2
ROLLER CARRIER
.116 GALV. STEEL
ATTACHED TO LIGHT COMMERCIAL TOP FIXTURE
WITH (2) TRACK BOLTS AND WHIZ NUTS

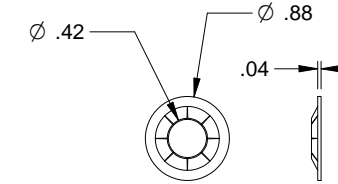

SCALE 1:1
RETAINING NUT

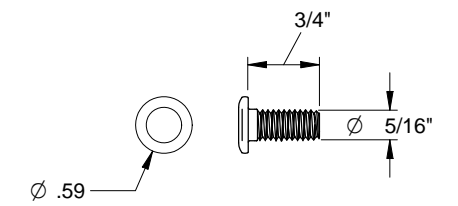

SCALE 1:1
TRACK BOLT

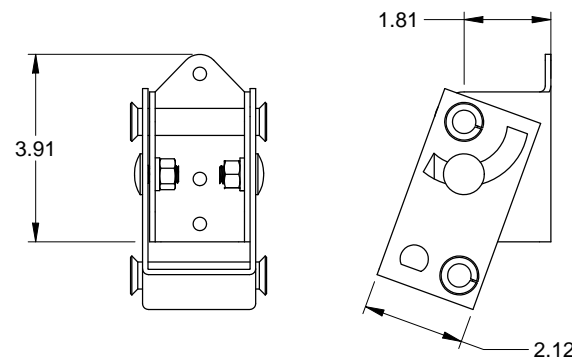

SCALE 1:2
HEAVY COMMERCIAL TOP FIXTURE
.116 GALV. STEEL

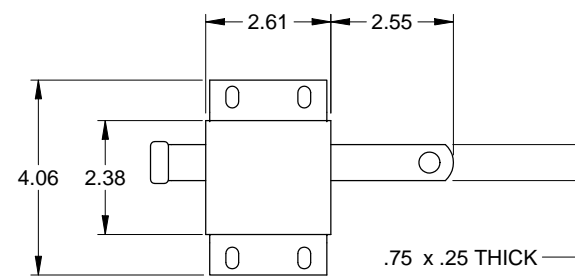

SCALE 1:
SLIDE LOCK (OPTIONAL)
CASE .086 GALV. STEEL

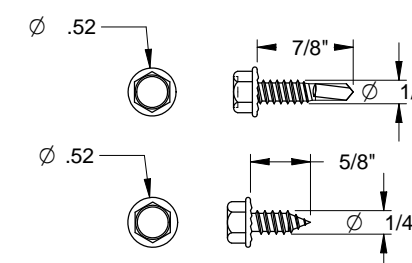

SCALE 1:1
SHEET METAL SCREW
BOTH STYLES ARE INTERCHANGABLE

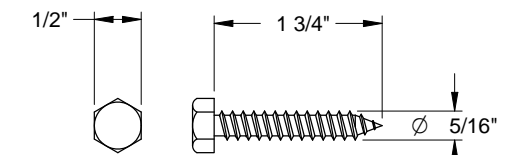

SCALE 1:1
HEX HEAD LAG SCREW

SCALE: NONE		DRAWN BY: G.WEDEKIND		RAYNOR GARAGE DOORS BOX 488 EAST RIVER ROAD DIXON, ILL. 61021		TITLE: SPEC, WIND LOAD ALUMAVIEW AND STYLEVIEW	
CHECKED BY: GW		DATE: 06/14/12		NO. P-2409		SHEET 3 OF 4	
ECN NO.		DATE		REV B			
REV.		DESCRIPTION		ECN NO.		DATE	

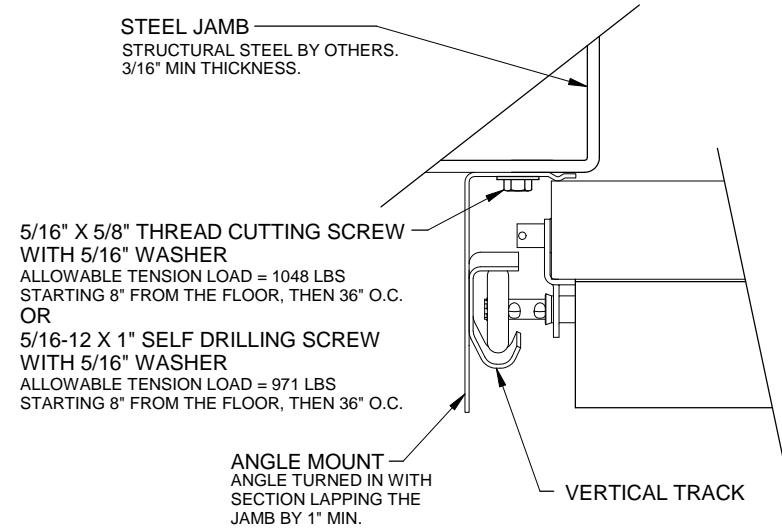

TRACK ASSEMBLY ATTACHMENT TO STEEL JAMB
2" TRACK ANGLE MOUNT TURNED IN SHOWN
3" TRACK ANGLE MOUNT AVAILABLE

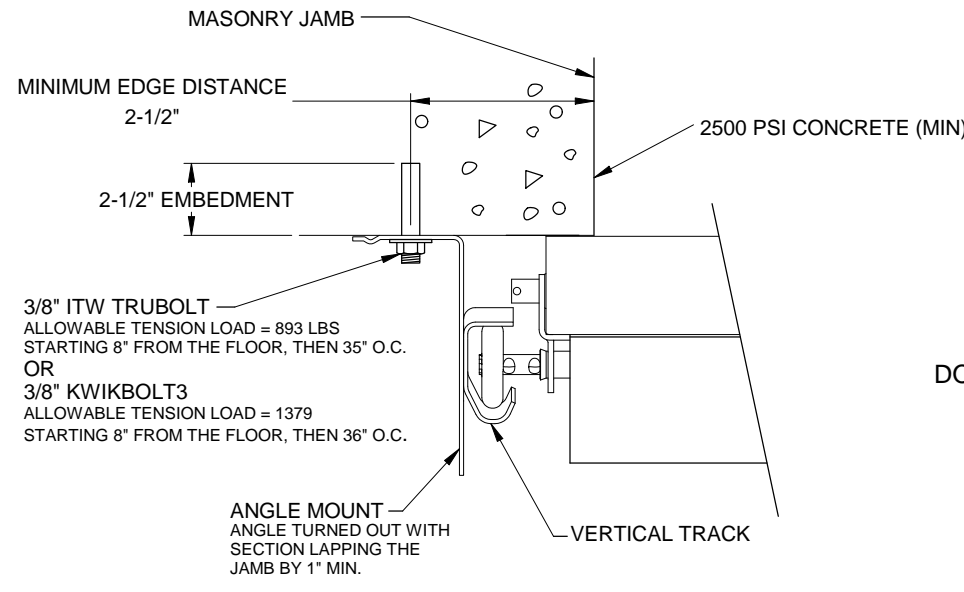

TRACK ASSEMBLY ATTACHMENT TO MASONRY JAMB
2" TRACK ANGLE MOUNT TURNED OUT SHOWN
3" TRACK ANGLE MOUNT AVAILABLE

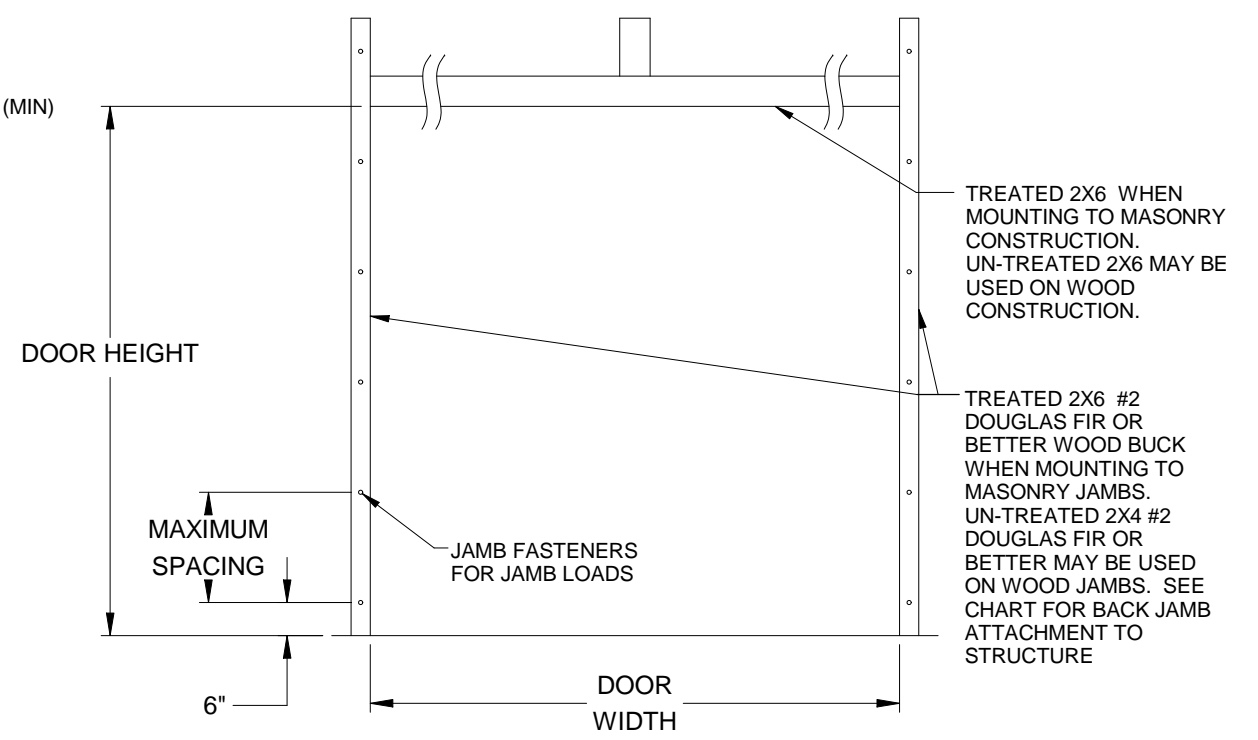

JAMB ATTACHMENT

JAMB ATTACHMENT NOTES

1. MAXIMUM POSITIVE LOAD PER JAMB = (14'-2" X 43.0 PSF) / 2 = 305 LBS PER FOOT
2. MAXIMUM NEGATIVE LOAD PER JAMB = (14'-2" X -48.0 PSF) / 2 = 340 LBS PER FOOT.
3. DESIGN OF THE SUPPORTING STRUCTURE SHALL BE THE SOLE RESPONSIBILITY OF THE BUILDING DESIGNER AND SHALL BE DESIGNED FOR THE JAMB LOADS LISTED IN NOTES 1 AND 2.
4. ALTERNATE JAMB ATTACHMENTS MAY BE USED IF APPROVED BY A REGISTERED PROFESSIONAL ENGINEER.
5. DASMA TECHNICAL DATA SHEET TDS-161 MAY BE USED FOR ALTERNATE JAMB ATTACHMENTS.
6. 3/8" DIAMETER LAG SCREWS REQUIRE 1/16" DIAMETER PILOT HOLE AND 1-1/2" MINIMUM EDGE DISTANCE.

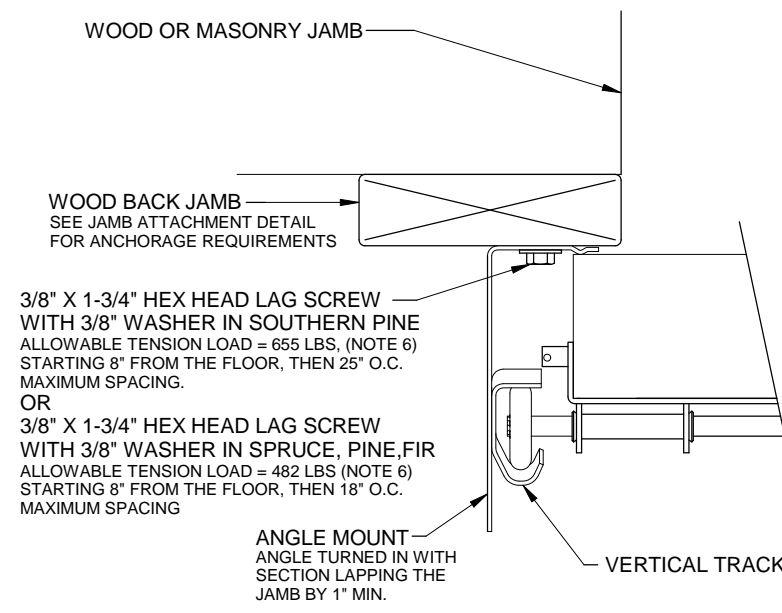

TRACK ASSEMBLY ATTACHMENT TO WOOD BACK JAMB
2" TRACK ANGLE MOUNT TURNED IN SHOWN
3" TRACK ANGLE MOUNT AVAILABLE

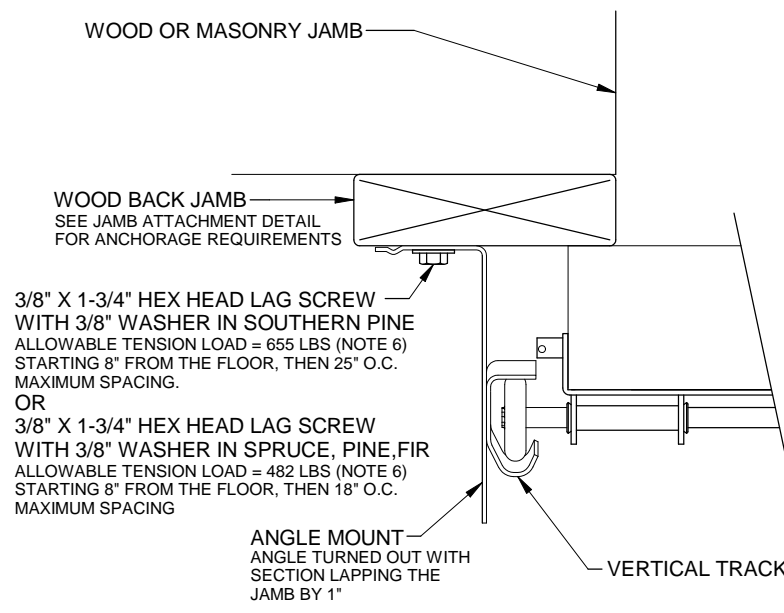

TRACK ASSEMBLY ATTACHMENT TO WOOD BACK JAMB
2" TRACK ANGLE MOUNT TURNED OUT SHOWN
3" TRACK ANGLE MOUNT AVAILABLE

2X6 ATTACHMENT TO STRUCTURE						
STRUCTURE TYPE	FASTENER TYPE	MINIMUM EMBEDMENT	MINIMUM EDGE DISTANCE	MINIMUM ON CENTER SPACING	DIMENSION A (MAXIMUM ON CENTER SPACING)	ALLOWABLE TENSION LOAD
2500 PSI MIN. CONCRETE	1/4" TAPCON+ (PLUS) WITH 1-1/8" OD WASHER	2"	2.5"	6"	24"	691
SOUTHERN PINE	3/8" X 3" LAG WITH 1-1/8" OD WASHER	1.50"	1.50"	1.50"	24"	655
SPRUCE PINE FIR	3/8" X 3" LAG WITH 1-1/8" OD WASHER	1.50"	1.50"	1.50"	18"	482

Scott A. Brown P.E.
F.P.E #65940
698 Timber Creek Road
Dixon Illinois 61021

SCALE: NONE		TITLE: SPEC, WIND LOAD ALUMAVIEW AND STYLEVIEW		
DRAWN BY: G.WEDEKIND		NO. P-2409	SHEET 4 OF 4	
CHECKED BY: GW				REV B
DATE: 06/14/12				
REV.	DESCRIPTION	ECN. NO.	DATE	ECN. NO.: 6338.01